



Uniclass L725111	EPIC G611
CI/SFB (74.26)	X

LSP-255 Anti Tamper Shower Head (Bottom Entry) Fitting Instructions

Step 1 Ensure that hot and cold water supplies are isolated (turned off) at isolation valves, stop cock or mains.

Step 2 Secure Wall attachment (brass to wall at appropriate height and position with stainless steel screws (not supplied)

Step 3 Remove any burs and sharp edges from end of supply pipework then insert 15mm supply pipe into pushfit receiver on the underside of the anti vandal unit. Take care not to pinch or damage the rubber retaining grommet on the inside of the pushfit as any damage to this will result in an insecure fit and leakage

Step 4 Loosen the stainless steel screw securing the ABS shower strainer making sure that all internals remain attached.

Step 5 Present the valve pipe brass along with ABS cover and internals up to the wall attachment (previously secured to the wall).

Step 6 Straighten the complete unit so that shower spray is pointing in the required direction and lock the unit in place by inserting lock screw M5 through the rear aperture in the ABS cover and tighten using alum key (do not over tighten)

Step 7 Tighten stainless steel screw through shower strainer which will tighten up and secure all internal parts (do not over tighten)

Step 8 Turn on water supplies and check the unit for leaks

Installation should only be undertaken by qualified plumbers

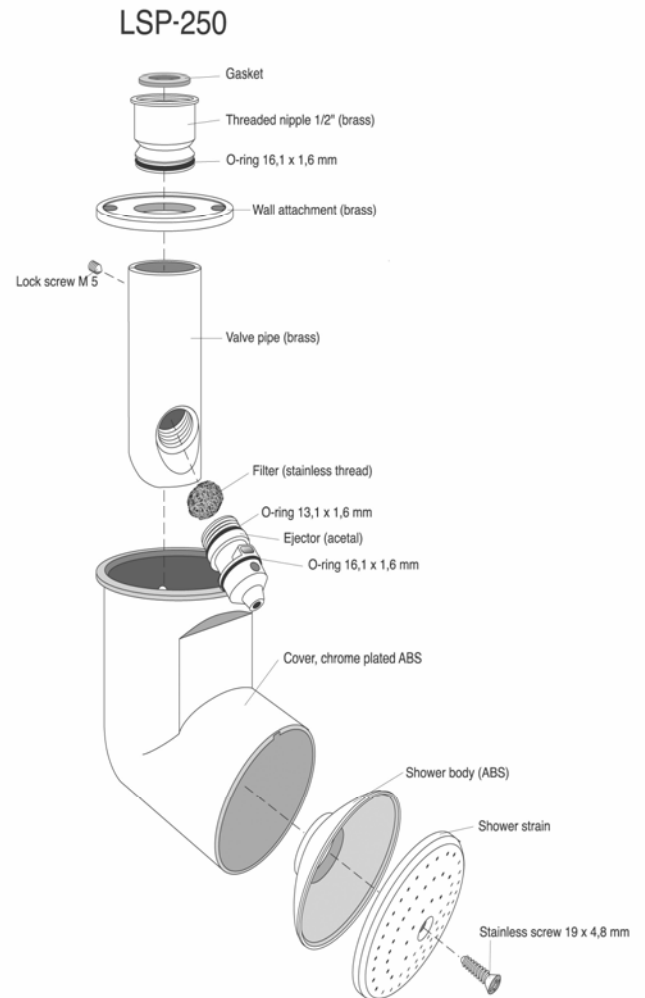

Aquiv8 255

