



Uniclass L725111	EPIC G611
CI/SfB (74.26)	X

LSP-250 Anti Tamper Shower Head Fitting Instructions

- Step 1** Ensure that hot and cold water supplies are isolated (turned off) at isolation valves, stop cock or mains.
- Step 2** Ensure inlet supply pipe work is secure in the wall terminated with brass threaded tube (standard BSP 15mm not supplied). Screw threaded nipple on to threaded tube using appropriate alum key.
- Step 3** Slip brass wall attachment over secured threaded nipple and secure to wall with stainless steel screws (not supplied)
- Step 4** Loosen the stainless steel screw securing the ABS shower strainer making sure that all internals remain attached.
- Step 4** Present the valve pipe brass along with ABS cover and internals up to the threaded nipple. Ensuring the o-ring is seated correctly and slip the valve pipe over the threaded nipple
- Step 5** Straighten the complete unit so that shower spray is pointing in the required direction and lock the unit in place by inserting lock screw M5 through the rear aperture in the ABS cover and tighten using alum key (do not over tighten)
- Step 6** Tighten stainless steel screw through shower strainer which will tighten up and secure all internal parts (do not over tighten)
- Step 7** Turn on water supplies and check the unit for leaks

Installation should only be undertaken by qualified plumbers

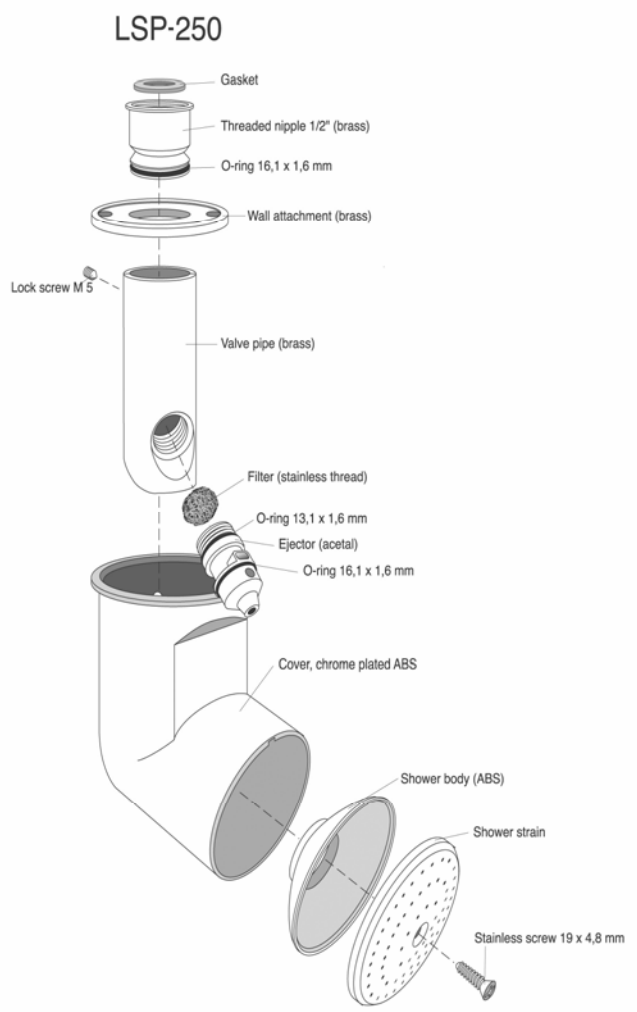

Aquiv8 250

